

DELTA CROSSING



MID-AMERICA
Real Estate-Michigan, Inc.

NEQ of W. Saginaw Highway & I-96 / Lansing, MI

FOR LEASE



RETAIL OPPORTUNITY

DELTA CROSSING



Address

NEQ of W. Saginaw Highway & I-96
Lansing, MI 48917

Features

Delta Crossing is located at the high-traffic intersection of W. Saginaw Highway and I-96 in Lansing, MI. Anchored by Hobby Lobby, TJ Maxx, Bob's Discount Furniture, and BJ's Wholesale Club, with Best Buy, Burlington and Bass Pro now under construction, the center offers strong national retail presence. Positioned directly across from Marketplace at Delta Township, home to a mix of major national retailers including: Walmart, Lowe's, PetSmart, Ross Dress For Less, Tractor Supply Co., and among others. Delta Crossing benefits from excellent visibility, accessibility, and a steady flow of shoppers.

Availability

7,200 - 88,300 SF

Area Tenants



Demographics (2024)

	1 MILE	3 MILES	5 MILES
POPULATION	6,284	28,596	65,393
HOUSEHOLDS	3,247	12,942	29,062
AVG HOUSEHOLD INCOME	\$84,869	\$96,700	\$89,189
DAYTIME POPULATION	7,498	35,101	75,396

DELTA CROSSING

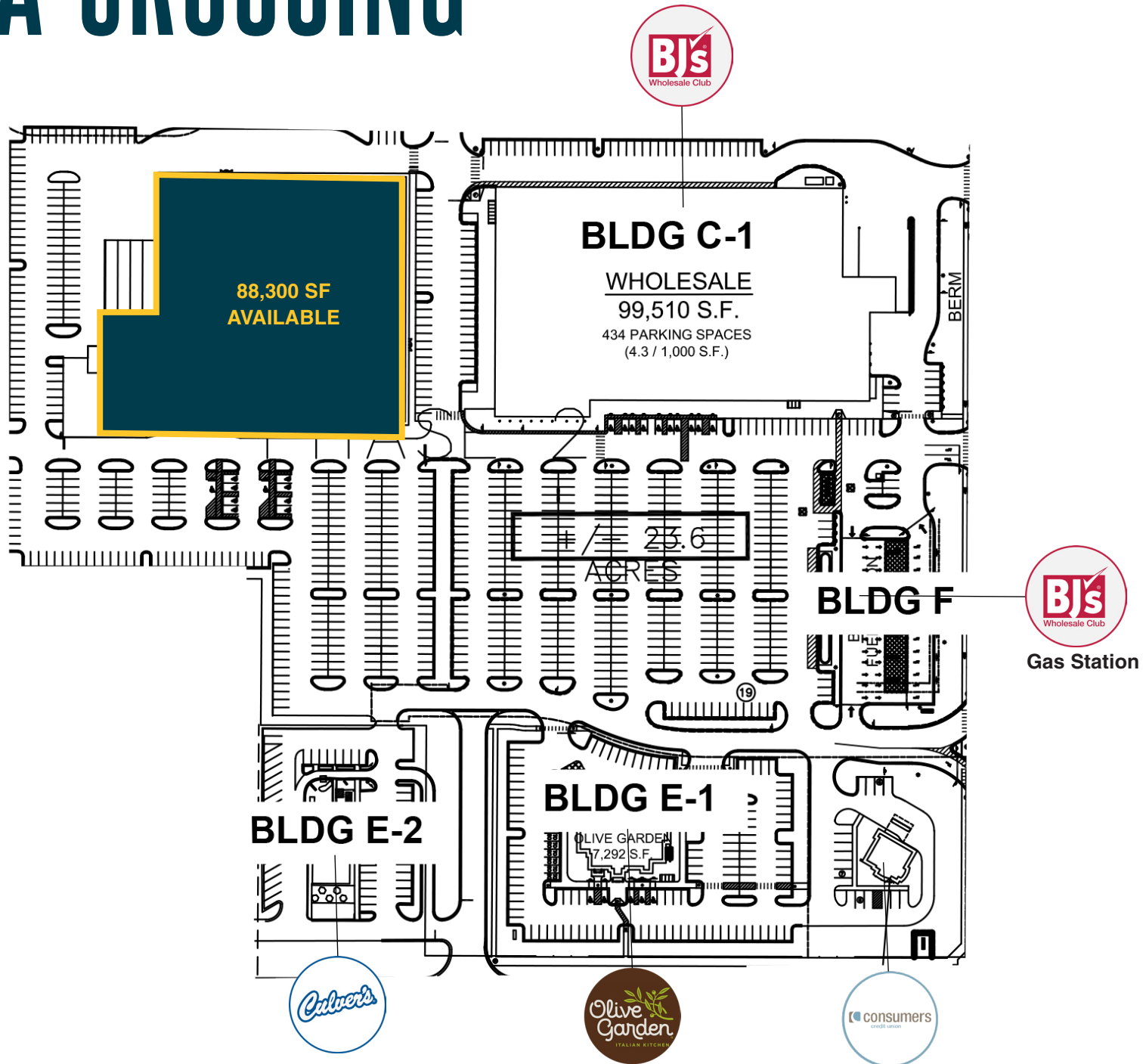

DELTA CROSSING

FUTURE RETAIL - 14 ACRES

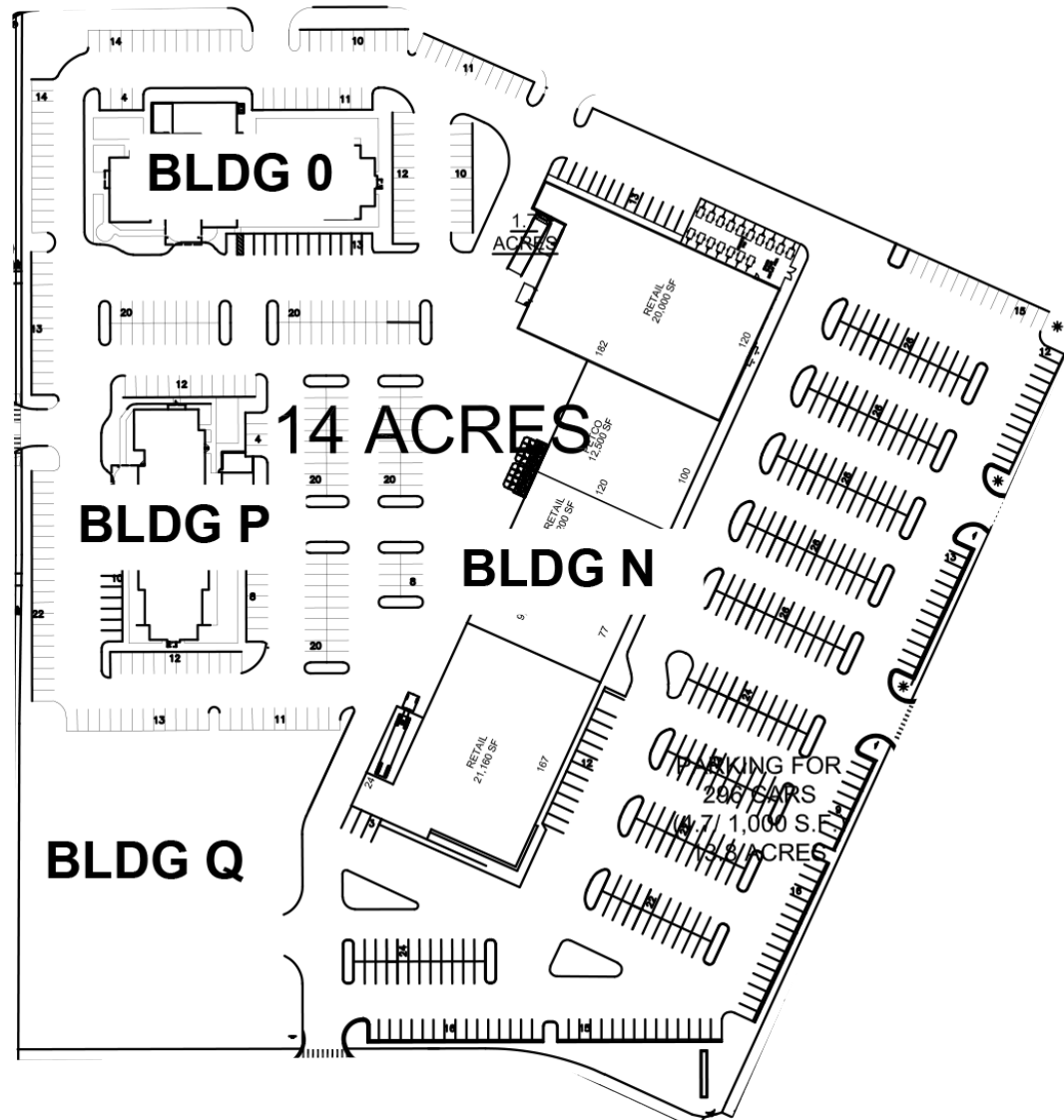

SITE PLAN - PHASE 5

DELTA CROSSING



DELTA CROSSING



Tony
Schmitt

Mid-America Real Estate -
Michigan, Inc.
T: 248.855.6800
TSchmitt@MidAmericaGrp.com

Eric
Unatin

Mid-America Real Estate -
Michigan, Inc.
T: 248.855.6800
EUnatin@MidAmericaGrp.com

Anthony
Mekani

Mid-America Real Estate -
Michigan, Inc.
T: 248.855.6800
AMekani@MidAmericaGrp.com



38500 Woodward Ave, Suite 100
Bloomfield Hills, Michigan 48304
248.855.6800
MidAmericaGrp.com